

DC Centrifugal Blower MBD Series

Impeller Diameter $\phi 120$ mm ($\phi 4.72$ in.)



Ambient Temperature: $-10 \sim +60^{\circ}\text{C}$ ($+14 \sim +140^{\circ}\text{F}$)
 Operating Voltage Range: $\pm 10\%$
 Materials
 Motor Case: Die Cast Aluminum
 Casing: Die Cast Aluminum
 Impeller: Aluminum
 Overheat Protection: Built-in Overheat Protection Circuit
 Bearings: Ball Bearings

Specifications (RoHS)

Model	Voltage VDC	Current A	Speed r/min	Max. Air Flow		Max. Static Pressure		Noise Level dB (A)
				m ³ /min	CFM	Pa	inH ₂ O	
MBD12-24	24	1.5	1900	3.0	106	372	1.49	58

● How to read specifications → Page E-19 ● Details of RoHS Directive → Page G-38

The following items are included in each product.
 Fan, Operating Manual

Air Flow – Static Pressure Characteristics

● How to read air flow – static pressure characteristics → Page E-20

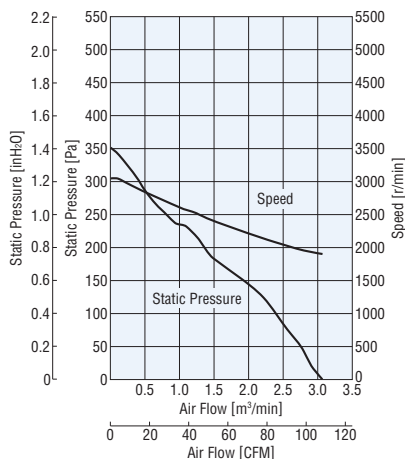

Dimensions Unit = mm (in.)

Mass: 1.5 kg (3.3 lb.)

DXF E031

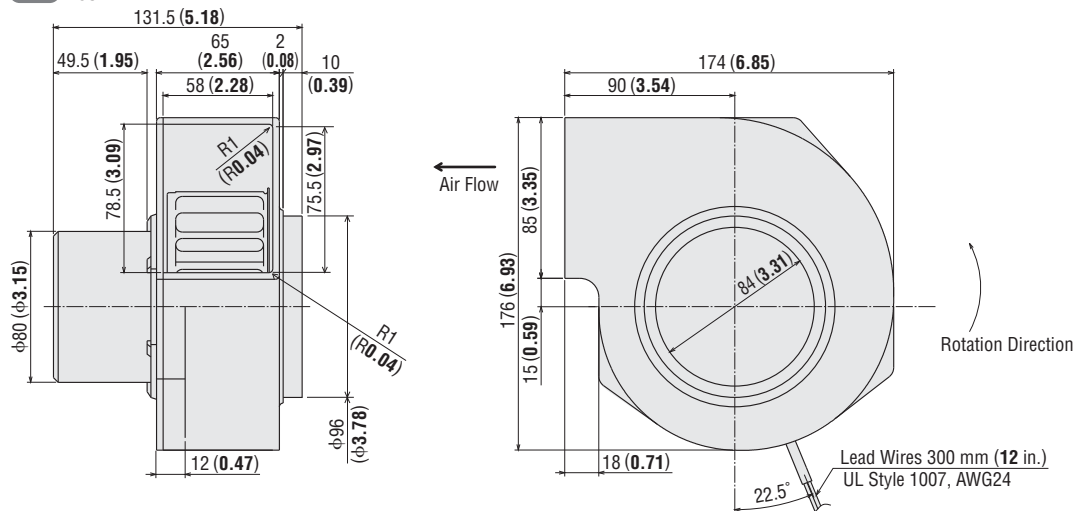

Panel Cut-Out Unit = mm (in.)

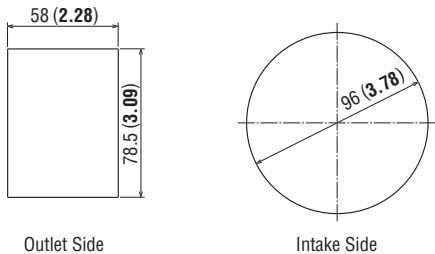

Connection Diagram

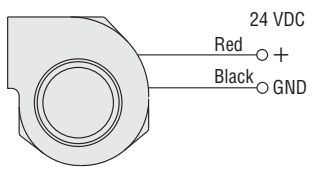

Accessories

The following products are RoHS-Compliant.
Details → Page E-137

Product	Model	Safety Standards	Page
Finger Guard	FGB12	Conformed component	E-145
Filter	FLB12	—	E-147
Mounting Bracket	PAS4B	—	E-152
Duct Joint	FD12	—	E-153

Fan Kit

The lineup includes a product configuration containing all necessary accessories in one package.

Details → Page E-143

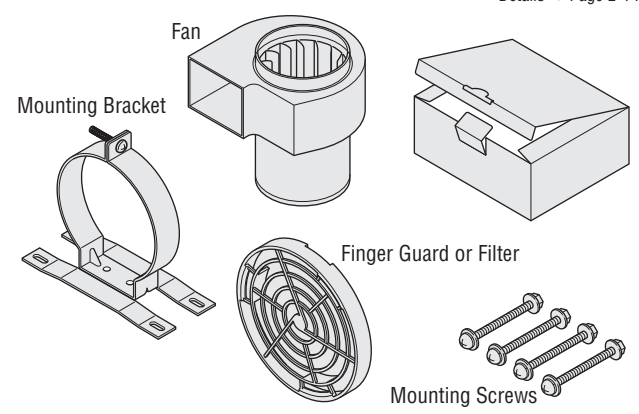

Product Line

Fan Kit Model
T-MBD12-24-GA
T-MBD12-24-FA

- **-GA** (Included with finger guard, mounting bracket and mounting screws)
- **-FA** (Included with filter, mounting bracket and mounting screws)

DC Centrifugal Blower MBD Series

Impeller Diameter $\phi 100$ mm ($\phi 3.94$ in.)



Ambient Temperature: $-10 \sim +60^{\circ}\text{C}$ ($+14 \sim +140^{\circ}\text{F}$)
 Operating Voltage Range: $\pm 10\%$
 Materials
 Motor Case: Die Cast Aluminum
 Casing: Die Cast Aluminum
 Impeller: Aluminum
 Overheat Protection: Built-in Overheat Protection Circuit
 Bearings: Ball Bearings

Specifications (RoHS)

Model	Voltage VDC	Current A	Speed r/min	Max. Air Flow		Max. Static Pressure		Noise Level dB (A)	
				m^3/min	CFM	Pa	inH ₂ O		
Low-Speed Alarm, Contact Alarm Type (Alarm specifications: ㉞)	MBD10-24A	24	1.0	2400	1.95	68.8	294	1.18	56
Pulse Sensor Type (Alarm specifications: ㉟)	MBD10-24S	24	1.0	2400	1.95	68.8	294	1.18	56
	MBD10-48S	48	0.7						
Standard Type	MBD10-24	24	1.0	2400	1.95	68.8	294	1.18	56
	MBD10-48	48	0.7						

● How to read specifications → Page E-19 ● Alarm specifications ㉞, ㉟ → Page E-21 ● Details of RoHS Directive → Page G-38

The following items are included in each product.
 Fan, Operating Manual

Air Flow – Static Pressure Characteristics

● How to read air flow – static pressure characteristics → Page E-20

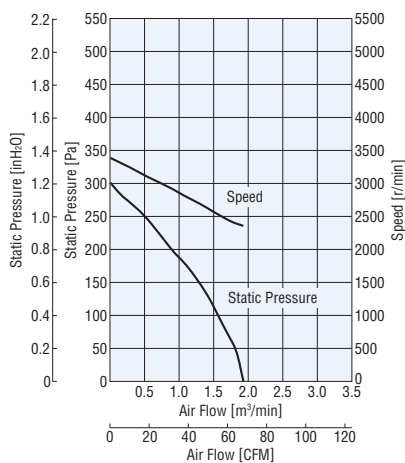

Dimensions Unit = mm (in.)

Mass: 1.2 kg (2.6 lb.)

DXF E032

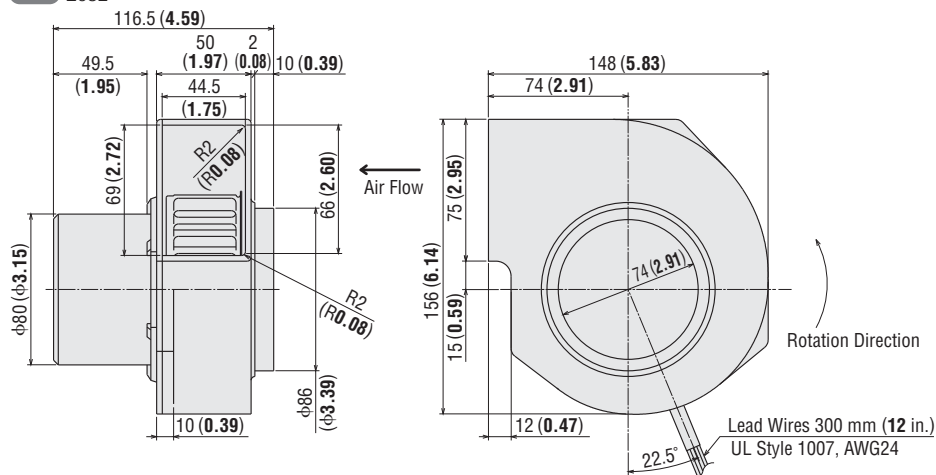

Panel Cut-Out Unit = mm (in.)

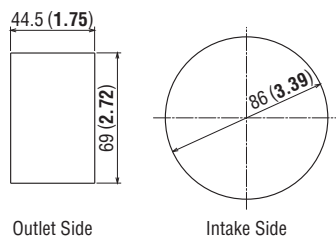

Connection Diagrams

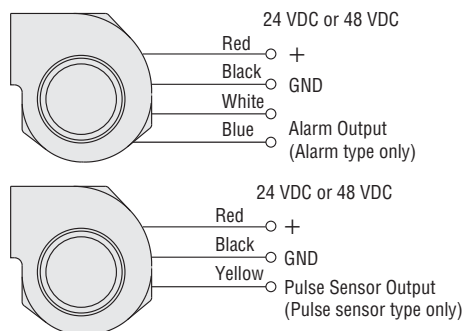

Accessories

The following products are RoHS-Compliant.

Details → Page E-137

Product	Model	Safety Standards	Page
Finger Guard	FGB10	Conformed component	E-145
Filter	FLB10	—	E-147
Mounting Bracket	PAS4B	—	E-152
Duct Joint	FD10	—	E-153

Fan Kit

The lineup includes a product configuration containing all necessary accessories in one package.

Details → Page E-143

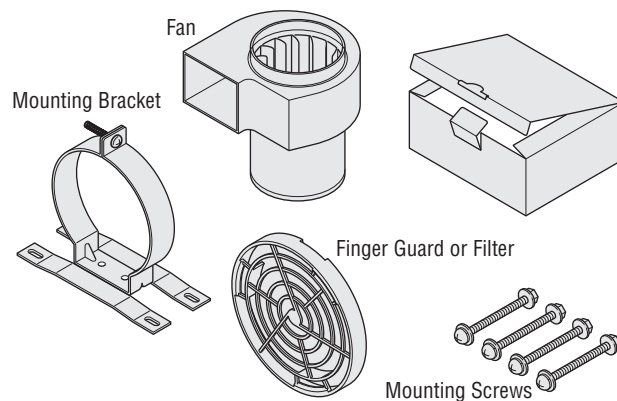

Product Line

Fan Kit Model
T-MBD10-24A-GA
T-MBD10-24A-FA
T-MBD10-24S-GA
T-MBD10-24S-FA
T-MBD10-24-GA
T-MBD10-24-FA
T-MBD10-48S-GA
T-MBD10-48S-FA
T-MBD10-48-GA
T-MBD10-48-FA

● **-GA** (Included with finger guard, mounting bracket and mounting screws)

● **-FA** (Included with filter, mounting bracket and mounting screws)

DC Centrifugal Blower MBD Series

Impeller Diameter φ80 mm (φ3.15 in.)



Ambient Temperature: $-10\sim+60^{\circ}\text{C}$ ($+14\sim+140^{\circ}\text{F}$)
 Operating Voltage Range: $\pm 10\%$
 Materials
 Motor Case: Die Cast Aluminum
 Casing: Die Cast Aluminum
 Impeller: Aluminum
 Overheat Protection: Built-in Overheat Protection Circuit
 Bearings: Ball Bearings

Specifications (RoHS)

Model		Voltage VDC	Current A	Speed r/min	Max. Air Flow		Max. Static Pressure		Noise Level
					m ³ /min	CFM	Pa	inH ₂ O	dB (A)
Low-Speed Alarm, Contact Alarm Type (Alarm specifications: ㉞)	MBD8-24A	24	0.7	2600	1.45	51.2	196	0.786	51
	MBD8-24S	24	0.7	2600	1.45	51.2	196	0.786	51
Pulse Sensor Type (Alarm specifications: ㉟)	MBD8-48S	48	0.5						
Standard Type	MBD8-24	24	0.7	2600	1.45	51.2	196	0.786	51
	MBD8-48	48	0.5						

● How to read specifications → Page E-19 ● Alarm specifications ㉞, ㉟ → Page E-21 ● Details of RoHS Directive → Page G-38

The following items are included in each product.
 Fan, Operating Manual

Air Flow – Static Pressure Characteristics

● How to read air flow – static pressure characteristics → Page E-20

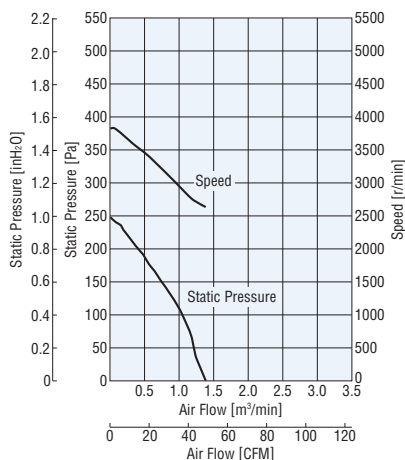

Dimensions Unit = mm (in.)

Mass: 1.1 kg (2.4 lb.)

DXF E033

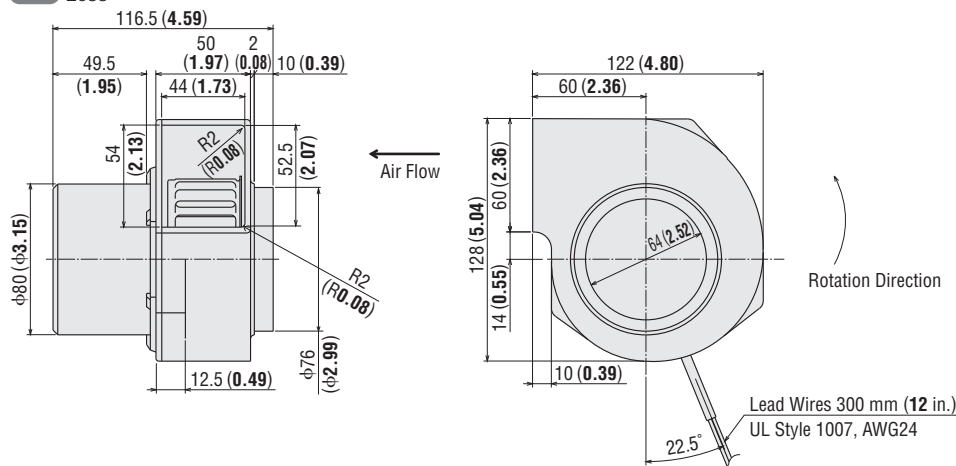

Panel Cut-Out Unit = mm (in.)

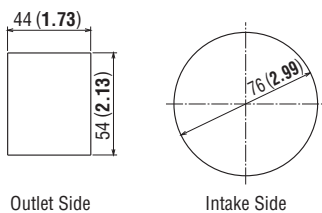

Connection Diagrams

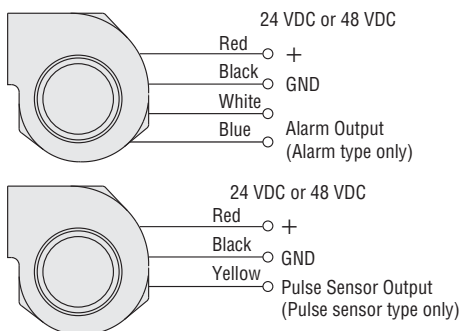

Accessories

The following products are RoHS-Compliant.

Details → Page E-137

Product	Model	Safety Standards	Page
Finger Guard	FGB8	Conformed component	E-145
Filter	FLB8	—	E-147
Mounting Bracket	PAS4B	—	E-152
Duct Joint	FD8	—	E-153

Fan Kit

The lineup includes a product configuration containing all necessary accessories in one package.

Details → Page E-143

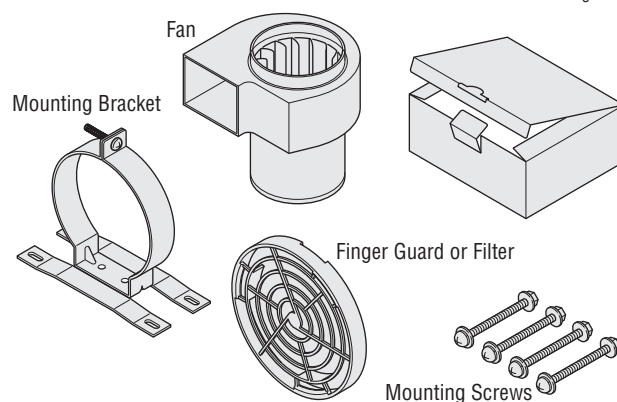

Product Line

Fan Kit Model
T-MBD8-24A-GA
T-MBD8-24A-FA
T-MBD8-24S-GA
T-MBD8-24S-FA
T-MBD8-24-GA
T-MBD8-24-FA
T-MBD8-48S-GA
T-MBD8-48S-FA
T-MBD8-48-GA
T-MBD8-48-FA

- **-GA** (Included with finger guard, mounting bracket and mounting screws)
- **-FA** (Included with filter, mounting bracket and mounting screws)

