

INDUCTION MOTORS

Single-Phase, Three-Phase

6W (1/124 HP)

Frame Size 2.36 in.sq.(60mm sq.)



Specifications — Continuous Rating



Model		Output Power	Voltage	Frequency	Current	Starting Torque	Rated Torque	Rated Speed	Capacitor			
Upper Model Name:Pinion Shaft Type	Lower Model Name():Round Shaft Type											
Lead Wire Type	Terminal Box Type	HP	W	V	Hz	A	oz-in	mN·m	oz-in	mN·m	r/min	μF
Dimension ①	Dimension ②											
2IK6GN-AWU (2IK6A-AWU)	2IK6GN-AWTU (2IK6A-AWTU)	Single-Phase 110		60	0.2	5.6	40	5.7	41	1450	2.5	
		Single-Phase 115		60								
2IK6GN-CWE (2IK6A-CWE)	2IK6GN-CWTE (2IK6A-CWTE)	Single-Phase 220		60	0.09	5.6	40	5.7	41	1450	0.6	
		Single-Phase 230		50								
		Single-Phase 230		60								
		Single-Phase 230		60								
2IK6GN-SW (2IK6A-SW)	2IK6GN-SWT (2IK6A-SWT)	1/124	6	Three-Phase 200		50	0.09	6.8	49	6.8	49	1200
				Three-Phase 200		60						
				Three-Phase 220		60						
				Three-Phase 230		60						
2IK6GN-AUL (2IK6A-AULA)	—	Single-Phase 115		60	0.18	5.6	40	5.6	40	1500	2	

- These products are impedance protected.
- The "U" and "E" at the end of the model name indicate that the unit includes a capacitor. These two letters are not listed on the motor nameplate. When the motor is approved under various safety standards, the nameplate is adopted.
- The terminal box type of the motors are not VDE approved.

Gearmotor — Torque Table

The maximum permissible torque with a decimal gearhead with a gear ratio of 10 is 26 lb-in (3N·m).

Single-Phase 115V/230V, Three-Phase 230V 60Hz

Unit = Upper values: lb-in / Lower values: N·m

Model	Speed r/min	Gear Ratio																			
		600	500	360	300	240	200	144	120	100	72	60	50	36	30	24	20	18	15	12	10
2IK6GN-AWU 2IK6GN-AWTU 2IK6GN-CWE 2IK6GN-CWTE 2IK6GN-SW 2IK6GN-SWT	2GN□KA	0.87	1.0	1.4	1.7	2.2	2.6	3.6	4.3	5.2	6.5	7.8	9.4	12	14	18	21	24	26	26	26
		0.10	0.12	0.17	0.20	0.25	0.30	0.42	0.50	0.60	0.75	0.90	1.1	1.4	1.6	2.0	2.4	2.7	3	3	3
2IK6GN-AUL / 2GN□KA		0.85	1.0	1.4	1.7	2.1	2.6	3.5	4.3	5.1	6.4	7.7	9.2	12	14	17	21	23	26	26	26
		0.097	0.12	0.16	0.19	0.24	0.29	0.41	0.49	0.58	0.73	0.88	1.1	1.3	1.6	2.0	2.4	2.6	3	3	3

Single-Phase 230V 50Hz

Unit = Upper values: lb-in / Lower values: N·m

Model	Speed r/min	Gear Ratio																			
		500	416	300	250	200	166	120	100	83	60	50	41	30	25	20	16	15	12.5	10	8.3
2IK6GN-CWE 2IK6GN-CWTE	2GN□KA	1.0	1.2	1.7	2.1	2.6	3.1	4.3	5.2	6.2	7.8	9.3	11	14	17	21	25	26	26	26	26
		0.12	0.14	0.20	0.24	0.30	0.36	0.50	0.60	0.71	0.89	1.1	1.3	1.6	1.9	2.4	2.9	3	3	3	3

- Gearheads are sold separately.
- Enter the gear ratio in the box (□) within the model number. A colored background indicates gear shaft rotation in the same direction as the motor shaft; a white background indicates rotation in the opposite direction.
- The speed is calculated by dividing the motor's synchronous speed (50 Hz: 1500r/min, 60 Hz: 1800 r/min) by the gear ratio. The actual speed is 2 ~ 20% less than the displayed value, depending on the size of the load.

■ Dimensions Scale 1/4, Unit = inch (mm)

① Motor/Gearhead

**2IK6GN-AWU
2IK6GN-CWE
2IK6GN-SW
2IK6GN-AUL**

Weight (Mass): 1.5 lb.(0.7 kg)

2GN□KA

Weight (Mass): 0.88 lb.(0.4 kg)

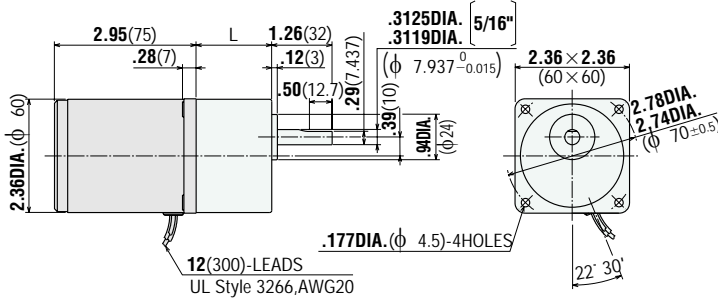

L = 1.18 (30) **2GN3KA~18KA**
L = 1.57 (40) **2GN25KA~180KA**

**2IK6A-AWU
2IK6A-CWE
2IK6A-SW
2IK6A-AULA**

Weight (Mass): 1.5 lb.(0.7 kg)

Round Shaft Type

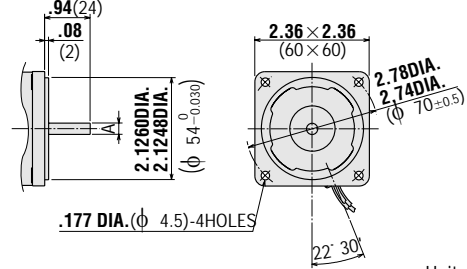

Unit = inch (mm)

Model	Shaft diameter A
2IK6A-AWU 2IK6A-CWE 2IK6A-SW	.2362DIA. .2357DIA. ($\phi 6^{+0.012}$)
2IK6A-AULA	.2500DIA. [1/4"] ($\phi 6.35^{+0.010}$) .2496DIA.

② Motor/Gearhead

**2IK6GN-AWTU
2IK6GN-CWTE
2IK6GN-SWT**

Weight (Mass): 1.7 lb.(0.75 kg)

2GN□KA

Weight (Mass): 0.88 lb.(0.4 kg)

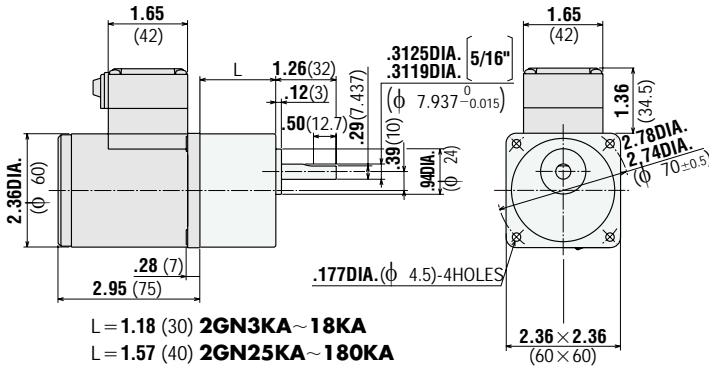

L = 1.18 (30) **2GN3KA~18KA**
L = 1.57 (40) **2GN25KA~180KA**

Use cabtyre cable with the diameter of .27DIA.($\phi 6.8$)~.34DIA.($\phi 8.6$).

**2IK6A-AWTU
2IK6A-CWTE
2IK6A-SWT**

Weight (Mass): 1.7 lb.(0.75 kg)

Round Shaft Type

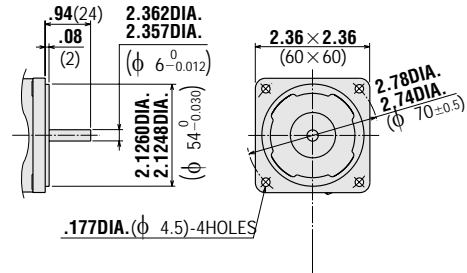

● Decimal Gearhead

2GN10XK Weight (Mass): 0.44 lb.(0.2 kg)

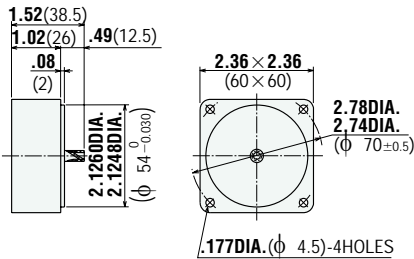

● **Capacitor** (included with the motor)

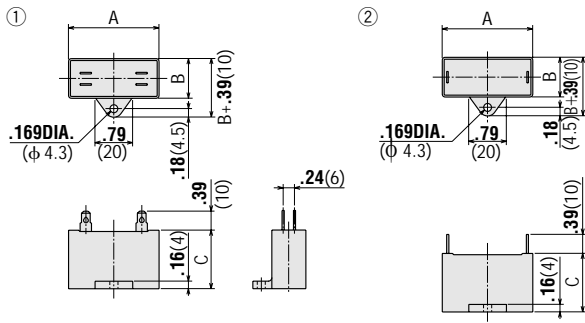

Motor Model	Capacitor Model	Dimensions in. (mm)			Weight (Mass) oz (g)	Dimension No.
		A	B	C		
2IK6GN-AW□U	CH25FAUL	1.22 (31)	.67 (17)	1.06 (27)	0.71 (20)	①
2IK6A-AW□U						
2IK6GN-CW□E	CH06BFAUL	1.22 (31)	.57 (14.5)	.93 (23.5)	0.53 (15)	①
2IK6A-CW□E						
2IK6GN-AUL	CH20UL	1.22 (31)	.57 (14.5)	.93 (23.5)	0.53 (15)	②
2IK6A-AULA						

If you need to order a capacitor without a motor, add "-C" to the capacitor model number shown. A capacitor cap is always included with a capacitor.

■ **Wiring Diagrams** The direction of motor rotation is as viewed from the shaft end of the motor.

Model	Lead Wire Type			Terminal Box Type	
	2IK6GN-AWU 2IK6GN-CWE	2IK6GN-SW	2IK6GN-AUL	2IK6GN-AWTU 2IK6GN-CWTE	2IK6GN-SWT
Direction					
CW					
CCW	To rotate the motor in a clockwise (CW) direction, flip switch SW to CW. To rotate it in a counterclockwise (CCW) direction, flip switch SW to CCW.	To change the rotation, change any two connections between U, V and W.		To rotate the motor in a clockwise (CW) direction, flip switch SW to CW. To rotate it in a counterclockwise (CCW) direction, flip switch SW to CCW.	To change the rotation, change any two connections between U, V and W.

Change the direction of motor rotation only after bringing the motor to a stop.

If an attempt is made to change the direction of rotation while the motor is rotating, the motor may ignore the reversing command or change its direction of rotation after some delay.

■ **Accessories**

● **Motor Mounting Brackets**

Optional die-cast aluminum mounting brackets are available. They can be used to install motors with or without gearheads. See page [A-266] for the dimensions.

Model name **SOL2U08**



● **Flexible Coupling**

Optional clamping couplings are available. See page [A-260] for the dimensions.

