

Many other useful features are also available

Various settings in addition to changing the display are possible

Various settings can be performed when removing the front panel.

- ▶▶ Blocks so that the settings are not changed
- ▶▶ Displays the status of a load
- ▶▶ Holds the load at motor standstill
- ▶▶ Accelerates the speed slowly

When the front panel is removed

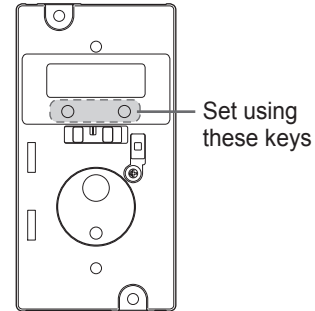

OPERATING MANUAL

Refer to "8 Convenient functions"

Controlling the motor using a programmable controller is possible

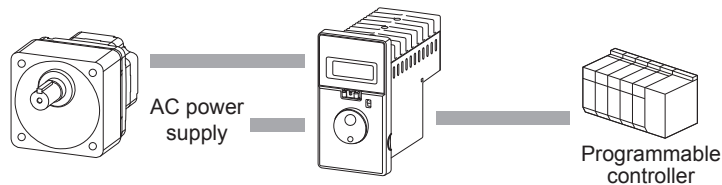

- ▶▶ Controls the motor operation externally
- ▶▶ Controls the motor operation with two or more speeds

OPERATING MANUAL

Refer to "7 Operating by programmable controller"

Orientalmotor



HM-5154-3

Be sure to ground the Protective Earth Terminal (ground terminal) to ensure the safe use of the product.

Refer to "1 Connecting" for details, and ground securely.

Brushless Motor and Driver Package

BMU Series

200 W / 300 W / 400 W

QUICK START GUIDE

Motor

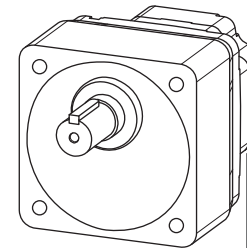

Protective Earth Terminal

Driver

Front side

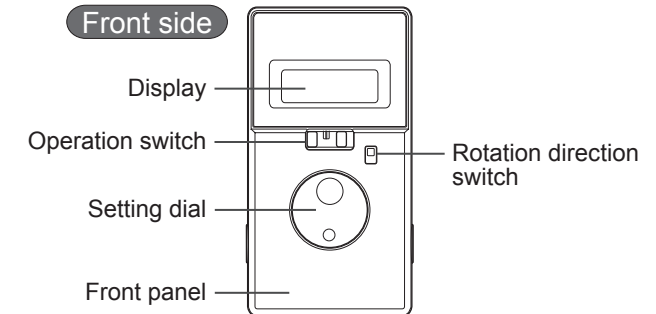

Rear side

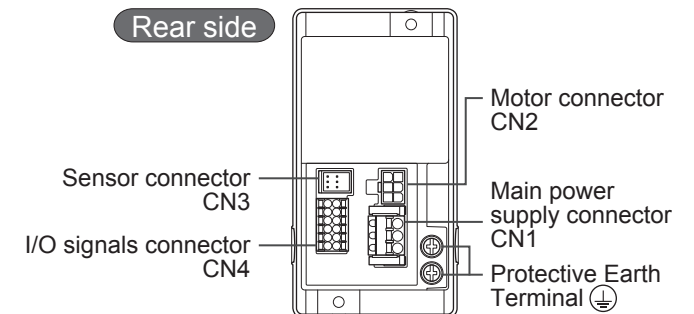

Thank you for purchasing an Oriental Motor product.

Use the product correctly after thoroughly reading the section "Safety precautions" of the operating manual. For more information about how to use the product, refer to the separate **OPERATING MANUAL**.

1 Connecting

OPERATING MANUAL

Refer to "5 Connection"

Insert the motor connector in the driver connector.

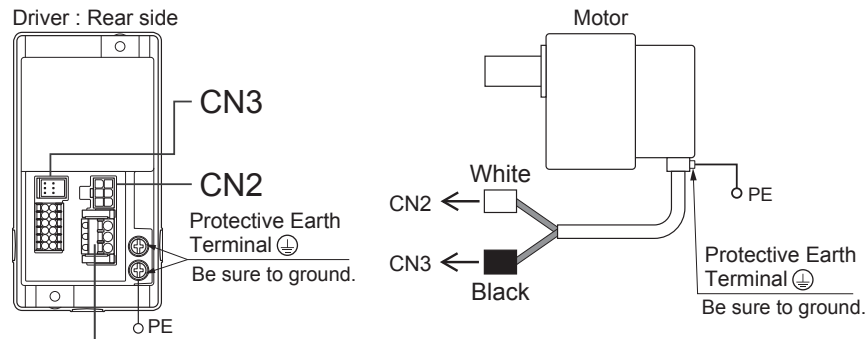

CN1: Connects to a power supply

- Ensure that the connector plugged in securely.
- Be sure to ground using the Protective Earth Terminal of the motor and the Protective Earth Terminal of the driver.

Note Be sure to ground the product. Failure to do so may result in electric shock or damage to the product. Static electricity may cause damage to the product if the Protective Earth Terminals are not grounded.

Connect an AC power supply to the CN1.

◆ Single-phase
100-120 VAC
: 2 wires

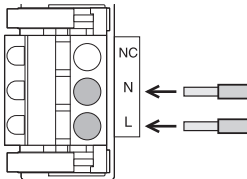

◆ Single-phase
200-240 VAC
: 2 wires

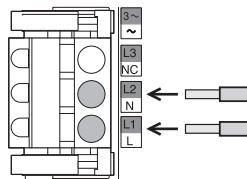

◆ Three-phase
200-240 VAC
: 3 wires

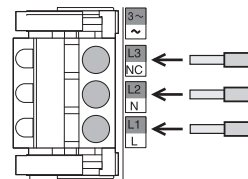

The 400 W type is indicated L1, L2, and L3 only.

Note Check the specification of the power supply voltage for the driver before applying a voltage. If a voltage exceeding the rated range is applied, the driver may be damaged.

Connecting the lead wire

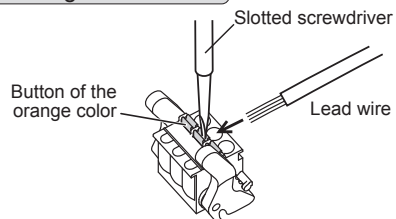

• Lead wire size:
AWG18 to 14 (0.75 to 2.0 mm²)

• Strip the insulation
cover of the lead wire
10 mm
(0.39 in.)

2 Operating a motor

OPERATING MANUAL

Refer to "6 Operating by front panel"

1 Turn on the AC power supply.

Turn on the power supply after connecting.

Display is lit



Indication: Rotation speed

2 Start the motor operation.

Switch the operation switch to the RUN side.

The motor starts rotating.

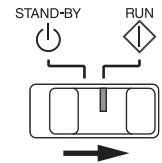

3 Change the speed.

Adjust the rotation speed using the setting dial of the front panel.

[Turn clockwise]
The rotation speed makes faster.

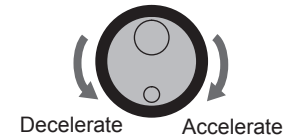

[Push]
The rotation speed has been set (stored).

The motor rotates at the set speed from the next time.

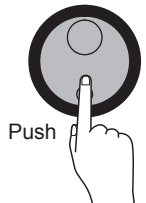

4 Stop the motor.

The motor stops when switching to the STAND-BY side.

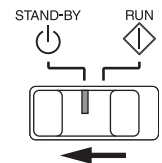

Changing the rotation direction

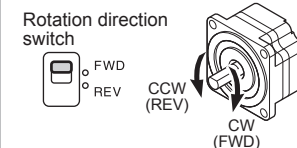

When **AL22**, **AL28**, etc.(alarm code) was displayed



Refer to "9 Alarms and warnings"

If it did not rotate,



OPERATING MANUAL

Refer to "10 Troubleshooting and remedial actions"